



Truist Center

214 N Tryon Street
Charlotte, NC 28202

Retail Space For Lease

Truist Center is located at N. Tryon and N. College St between 5th & 6th St.



Light Rail Stations



TRUIST CENTER

KEY OFFICE TENANTS
+ RETAIL COTENANTS

Major Office Tenants

- > Truist, 561,000 SF
- > PriceWaterhouseCoopers, 62,891 SF
- > U.S Bank, 45,550 SF
- > Bradley, 36,147 SF
- > Mayer Brown LLP, 35,197 SF
- > Service Logic, 20,974 SF
- > Dixon Hughes Goodman LLP, 13,182 SF

Retail Tenants

- > Sea Level
- > Showmars Restaurant
- > Luce
- > Soho Bistro
- > RiRa Sandwich Shop
- > Truist Branch (*coming soon*)

UPTOWN CHARLOTTE

RETAILERS + ATTRACTIONS
IN THE AREA

Area Retailers & Attractions

- | | | |
|--------------------------------|-----------------------------|---------------------|
| > Foundation for the Carolinas | > The Capital Grille | > Rooster's |
| > Belk Theater | > Forchetta | > BLT Steak |
| > McGlohon Theater | > Mert's | > 5Church |
| > Levine Museum | > The Cellar at Duckworth's | > Sabor Latin Grill |
| > Discovery Place | > Sophia's Lounge | > First Ward Park |
| > 7th St. Public Market | > The Asbury | > Fourth Ward Park |
| | > Stoke | |

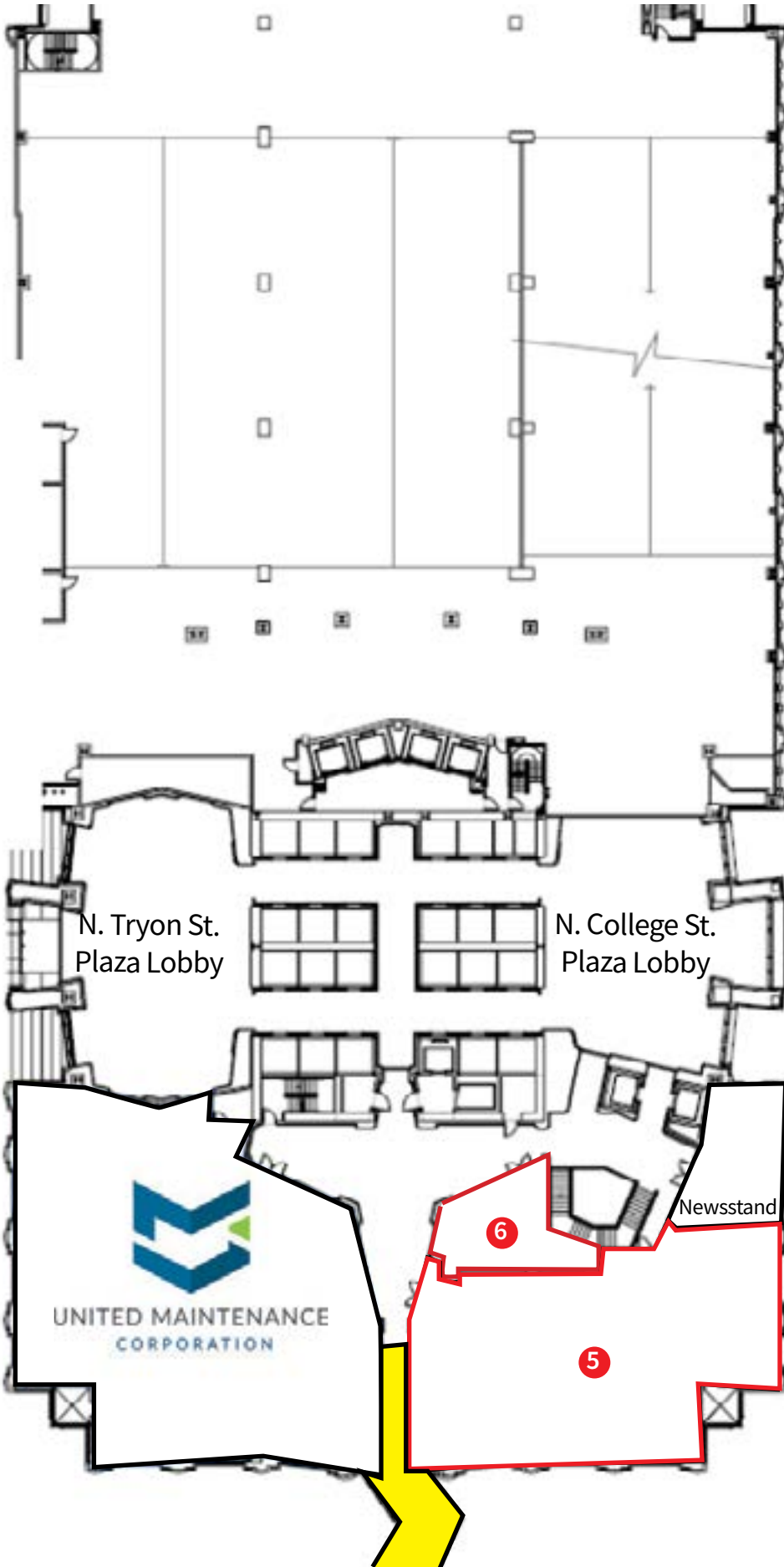

Spaces Available

SUITE 5

- > Current Showmars
- > Level 2
- > ±4,095 SF

SUITE 6

- > Former Jewell Treats
- > Level 2
- > ±622 SF
- > Adjacent to Showmars

Access to Overstreet Mall

CONNECTIVITY

- > 1.5 miles of walkways + skybridges from Duke Energy Center to Truist Center

ACCESS + AMENITIES

- > 8.5M SF of office + retail along the mall
- > 81 restaurants + retail offerings
- > ±11K parking spaces accessible along Overstreet Mall





DEMOGRAPHICS	1-mile	3-mile	5-mile
Estimated Population	24,338	124,028	263,020
Estimated Households	12,911	57,673	112,781
Average Household Income	\$121,790	\$103,074	\$91,245
Median Age	31.1	34.2	34.7
Daytime Business Employees	45,664	130,283	210,260

Source: Esri, 2022

For more information:

Sara Hogan
 Vice President
 +1 704 804 5840
 sara.hogan@am.jll.com

Mary McLanahan
 Associate
 +1 704 609 9322
 mary.mclanahan@am.jll.com



Although information has been obtained from sources deemed reliable, JLL does not make any guarantees, warranties or representations, express or implied, as to the completeness or accuracy as to the information contained herein. Any projections, opinions, assumptions or estimates used are for example only. There may be differences between projected and actual results, and those differences may be material. JLL does not accept any liability for any loss or damage suffered by any party resulting from reliance on this information. If the recipient of this information has signed a confidentiality agreement with JLL regarding this matter, this information is subject to the terms of that agreement. ©2022. Jones Lang LaSalle IP, Inc. All rights reserved.