

# ANAHEIM PLAZA

N. Euclid Street & Santa Ana Freeway  
Anaheim, California



**NEWMARK**

**3 RETAIL SPACES FOR LEASE**



# Highlights

Anaheim Plaza is a 348,524 SF shopping center. It is owned and operated by Kimco Realty Corp., one of North America's largest publicly traded owners and operators of open-air shopping centers, it is our mission to create the perfect destination for everyday living. Our anchor stores include El Super, Petco, T.J.Maxx, and Walmart, making Anaheim Plaza a great shopping destination in the heart of Anaheim, CA.



- Seeking dynamic uses in entertainment, fitness, and soft goods
- Extremely dense trade area with healthy average incomes
- Excellent visibility from both the I-5 freeway and Euclid Street and is very well positioned in the trade area
- Great co-tenancy that includes Walmart, El Super, Smart & Final and T.J.Maxx
- Close proximity to popular shopping centers, Disneyland, Anaheim Convention Center, Angel Stadium and Honda Center
- Ample parking
- Great signage opportunities



## 2022 Demographics

	1 Mile	3 Miles	5 Miles
Population	34,505	278,843	677,037
Average HH Income	\$94,735	\$99,947	\$107,345
Daytime Population	30,560	286,721	677,836

### Traffic Counts

N. Euclid Street	55,000
W. Crescent Avenue	11,000



2,232  
Parking Spaces

6.4/1,000  
Parking Ratio

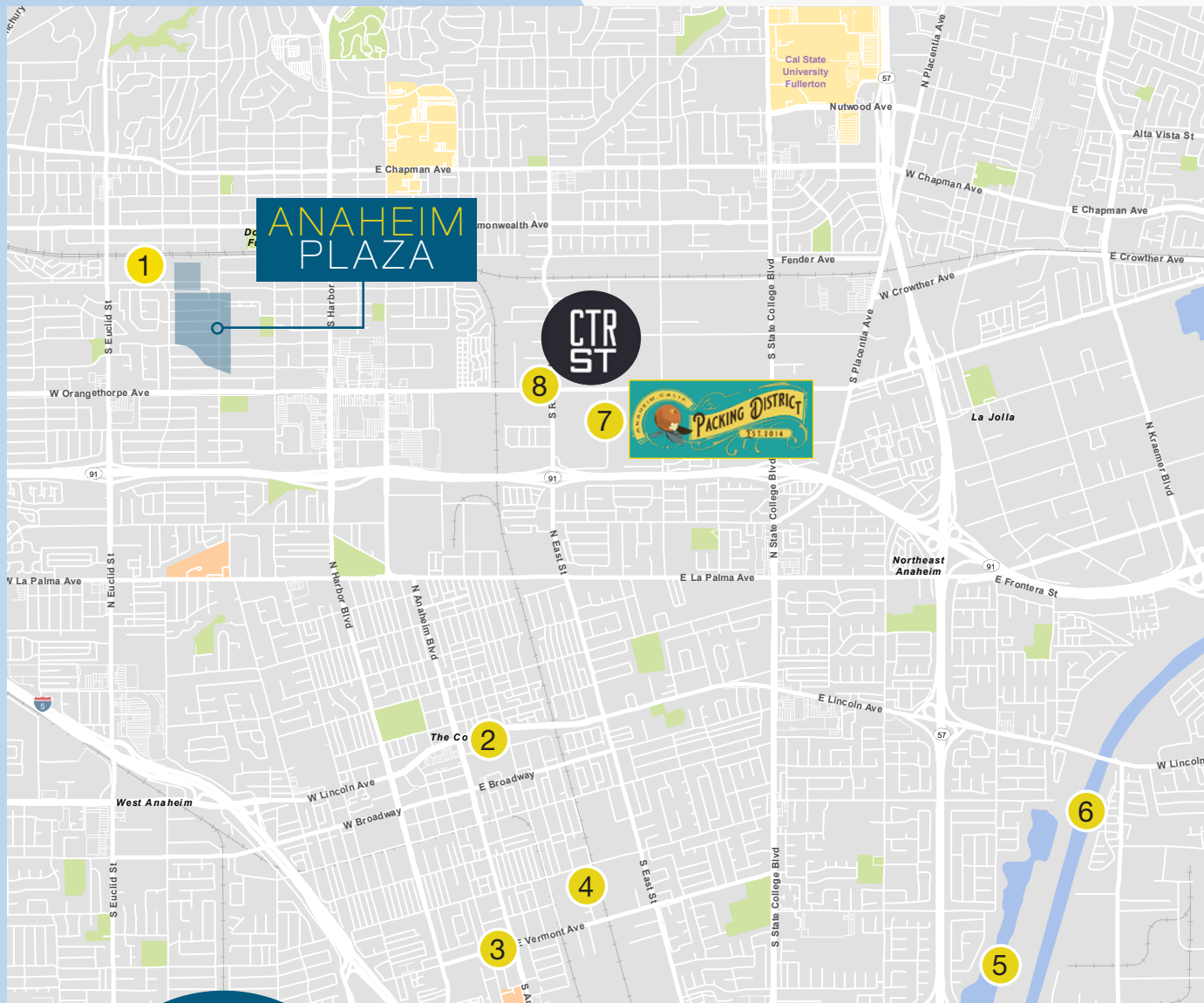

## Nearby Amenities & Entertainment

1. Euclid Plaza
2. Disneyland
3. Convention Center
4. Anaheim Gardenwalk
5. Angel Stadium
6. Honda Center
7. Anaheim Packing District

25 Restaurants  
15 Entertainment  
14 Retail Shops

▶ 206 BCE  
ADYA  
Black Sheep GCB  
Chippy Fish & Grill  
Crepe Coop  
BXCR  
Georgia's Kitchen  
Hammer Bar  
Healthy Junk at the House  
Kettlebar  
Mangal  
The Blind Rabbit  
The Iron Press  
Urbana  
The Kroft  
Zabon Ramen  
White Elephant  
18 Folds  
Poppy and Seed  
Monkish Brewing  
Umami Burger  
Pali Wine Company  
Unsung Brewing Company

### 8. Center Street Promenade

▶ Cervantes Mexican Kitchen  
Craft  
House of Chimney Cakes  
K&A Cafe  
Lazy Bird  
Okayama dobo  
Preso Tea  
Promenade Pizza  
Lazeez Eats  
Windor Brown's

Entertainment,  
Restaurants &  
Shopping  
Galore!

*to name a few...*

# Current Availabilities



## Tenants SF

1	Bank of America	5,000
2	Party City	9,400
3	AAA Auto Club	9,800
4	Petco	12,000
5	Fashion Q	9,942
6	America's Best Contacts & Eye	4,000
7	Carter's	4,965
8	Burlington	26,258
9A	Available	10,000
9B	New Tenant Coming Soon	42,250
10	Crumbl Cookies	1,341
11	Baskin-Robbins	994
12	Subway	1,260
13	Lantern Garden	1,295
14	Available	3,284
15	Rubio's Fresh Mexican Grill	3,001
16	In-N-Out Burgers	10,183
17	T.J.Maxx	26,000
18	Ross Dress For Less	27,200
19	Old Navy	15,970
20	Ulta	11,024
21	Verizon	1,320
22	Supercuts	1,344
23	Daniel's Jewelers	1,390
24	Available	1,931
25	Five Below	8,000
26	SchoolsFirst FCU	6,135
27	Citibank	5,800
28	Smart & Final	30,000
29	El Super	54,087
30	Wendy's	3,500

# Suite 9A Floor Plan

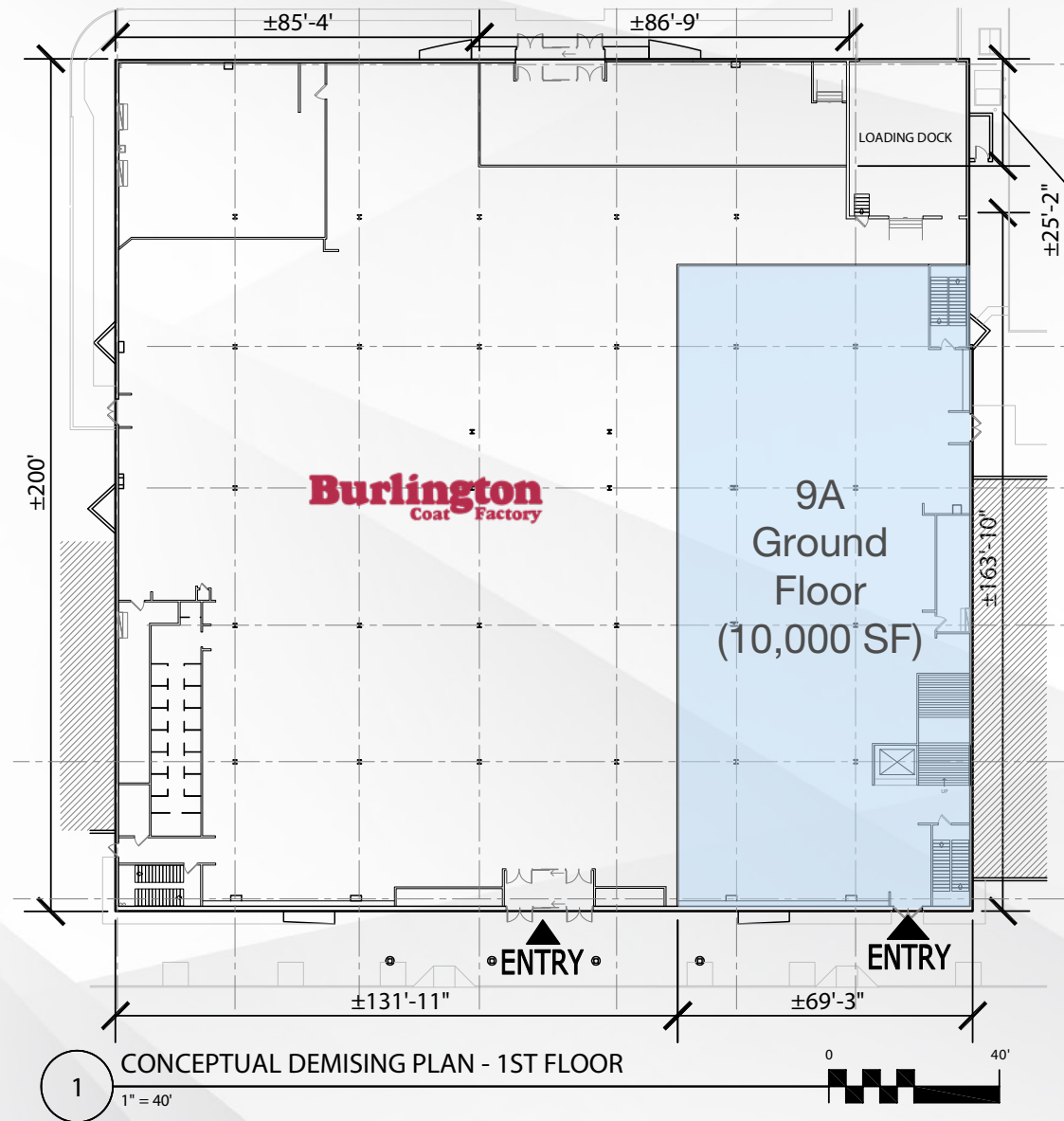



# ANAHEIM PLAZA

N. Euclid Street & Santa Ana Freeway  
Anaheim, California

---

Prepared by:

**Mark Baziak**

Senior Managing Director

CA RE Lic. #01202116

t 949-608-2049

mark.baziak@nmrk.com

Corporate License #01355491

The distributor of this communication is performing acts for which a real estate license is required. The information contained herein has been obtained from sources deemed reliable but has not been verified and no guarantee, warranty or representation, either express or implied, is made with respect to such information. Terms of sale or lease and availability are subject to change or withdrawal without notice.

**NEWMARK**